

General Notes
DO NOT SCALE. All dimensions must be checked on site, errors are to be reported.

All illustrated material is subject to copyright. Unless otherwise agreed in writing, all rights to use this document are subject to payment of Architect's charges. This document may only be used for the express purpose and project for which it has been created and delivered, as notified in writing by the Architect. This document may not be otherwise used or copied. Any unauthorised use of this document is at the user's sole risk and without limiting the Architect's rights the user releases and indemnifies the Architect from and against all loss so arising.

Contractors must ensure that cross referenced drawings and specifications noted on these drawings are checked on a regular basis to ensure that the latest revisions are used.

- Key**
- Phases A to G Hybrid application boundary
 - Phase C Detailed application boundary
 - Area benefitting from RMA approval (not to be reviewed through this application)
 - Borough boundary

- A** Apartment development zone letter
- 11** House development zone number
- S1** School development zone alphanumeric code
- S2**

Drawing Notes

- School areas excluded from phasing.
- Boundaries indicate development zone phasing. Refer to engineer drawings for enabling and ground works required.

- Phasing Key**
- | | |
|---|--|
| Phase A | Phase B |
| Phase C | Phase D |
| Phase E | Phase F |
| Phase G | Phase of LBBD school / LBH school
To be provided by the local authority |

Key plan - Phases A to G

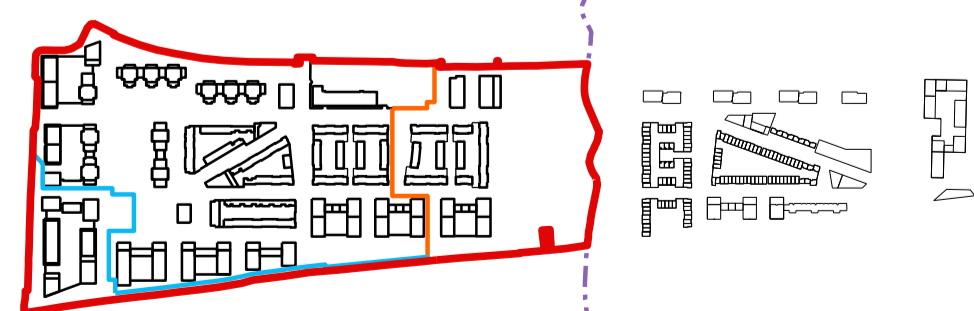

Client
Countryside
Countryside House
The Drive, Great Warley
Brentwood CM13 3AT
+44(0)1277 260000

Client
L&Q
10 Grove Crescent Road
Stratford, London E15 1BJ
+44(0)20 8012 2355

Stakeholder
Greater London Authority
City Hall, Kamal Chunchie
Way, London E16 1ZE
+44(0)20 7983 4000

Architect
Patel Taylor
48 Rawstorne Street
London EC1V 7ND
+44(0)20 7278 2323

Title
Phasing with Illustrative Masterplan
LBBD Phases A to G Hybrid Application

Project
Beam Park

Scale
1:2000 @ A1 1:4000 @ A3

Issue Record **By** **Chk** **Date**

PL2 For Information EB SR 08.11.2022
PL1 For Information EB SR 13.05.2022

Drawing Number
448-PTA-MP-00-DR-A-C-0105 PL2

Revision

Status
For Information

Patel Taylor
48 Rawstorne Street
London EC1V 7ND
T +44 (0)20 7278 2323
www.patel-taylor.co.uk

Patel Taylor